

328 ROGERS AVENUE, BROOKLYN, NY 11225

FOR LEASE

660 SF GROUND FLOOR RETAIL SPACE WITH EXCELLENT STREET FRONTAGE & VISIBILITY

Between Sullivan Place & Montgomery Street



SHLOMI BAGDADI
212.433.3355 x101
sb@tristatecr.com

CHARLES ELBAZ
212.433.3355 x1014
charles.e@tristatecr.com

TRI STATE COMMERCIAL®

PROPERTY SUMMARY

LOCATION

Located in the Prospect Lefferts Garden neighborhood of Brooklyn.

HIGHLIGHTS

- Located in a High-Foot-Traffic and Heavy Vehicle Traffic Area
- Steps From Major Subway and Bus Lines With Convenient Access to Public Transit
- Surrounded by Local Boutiques, Dining, and Vibrant Nightlife
- Situated in a Highly Walkable Neighborhood With Dense Residential Population Nearby

SPACE DETAILS

- Brand New Glass Storefront in Move-In Ready Condition
- Clean Vanilla Box Space With High-Visibility Exposure

TRANSPORTATION

2 **5** Trains at Sterling Street

B49 **B43** **B44-SBS** **B44** Bus Lines

NEIGHBORS

Dunkin', Domino's Pizza, All My Children Daycare & Nursery School, Peoples Deli & Grocery, MRK Computer Services Inc, Pearl Lee's Washtub, La Estrella Del Castillo, I Love My Pet Food and Supplies, NYC FAST PRINT, Brooklyn Miracle Temple, Everything Mattress, Balboa, and more!



FLOOR PLANS

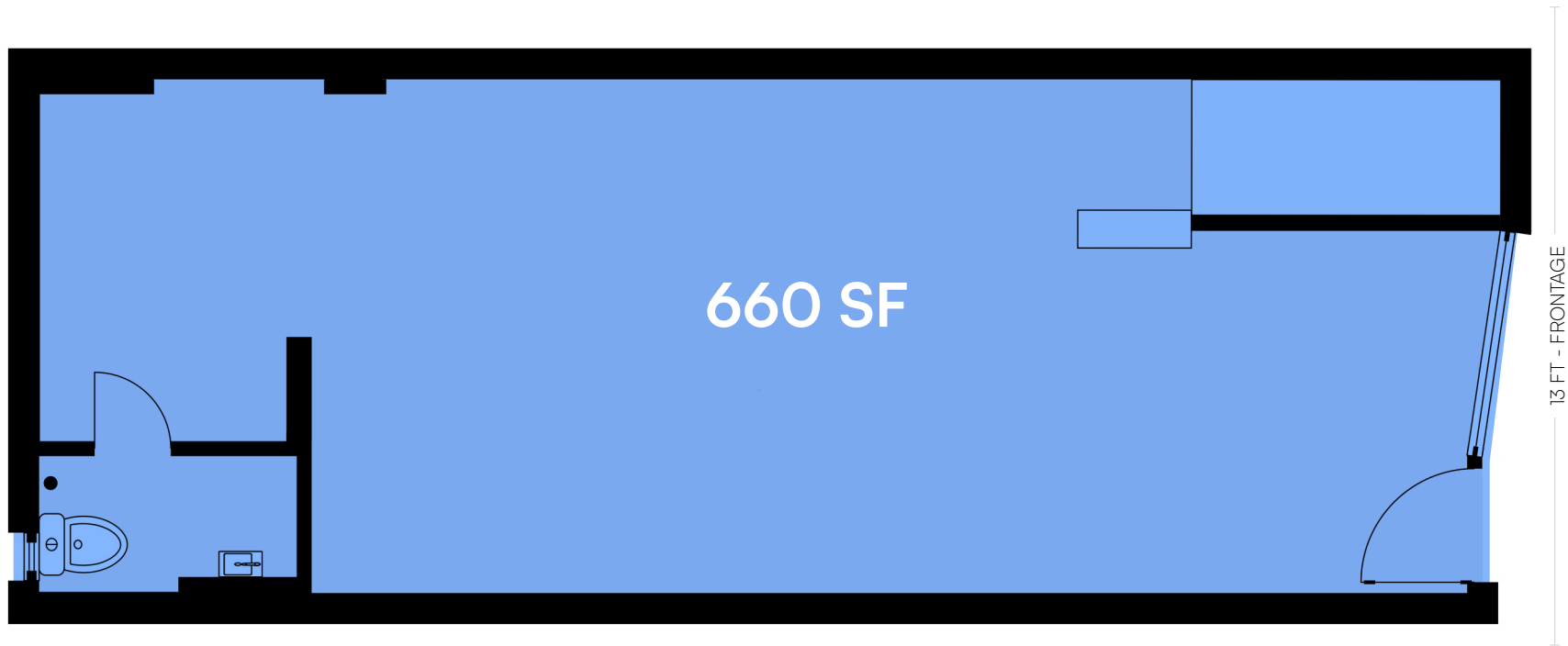

All square footages are approximate

PROPERTY PHOTOS



RETAIL MAP

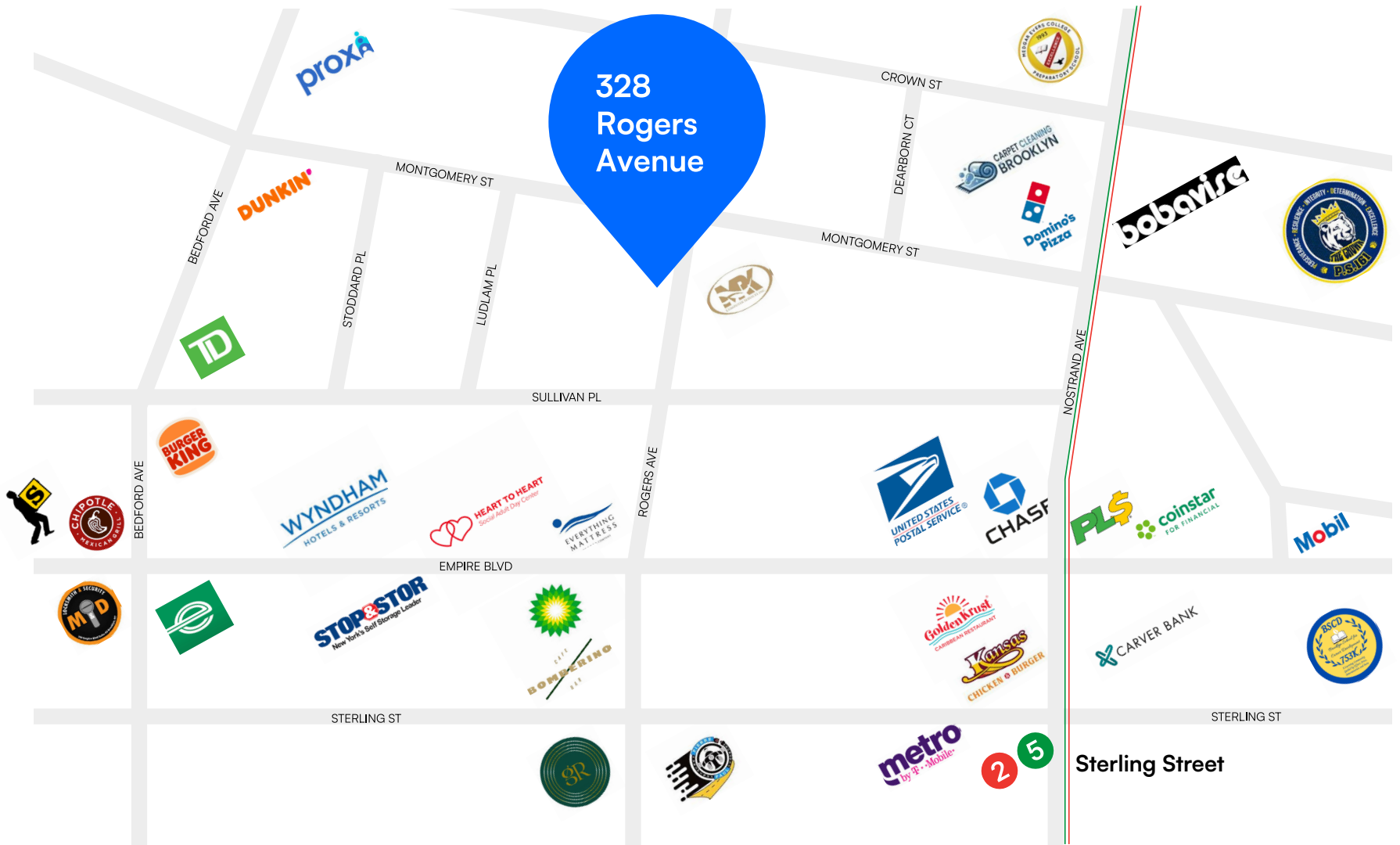

328 ROGERS AVENUE, BROOKLYN, NY 11225

660 SF GROUND FLOOR RETAIL SPACE WITH EXCELLENT STREET FRONTAGE & VISIBILITY

Between Sullivan Place & Montgomery Street

For Pricing Call: **212.433.3355**

SHLOMI BAGDADI
212.433.3355 x101
sb@tristatecr.com

CHARLES ELBAZ
212.433.3355 x1014
charles.e@tristatecr.com

TSC.